

### Overview

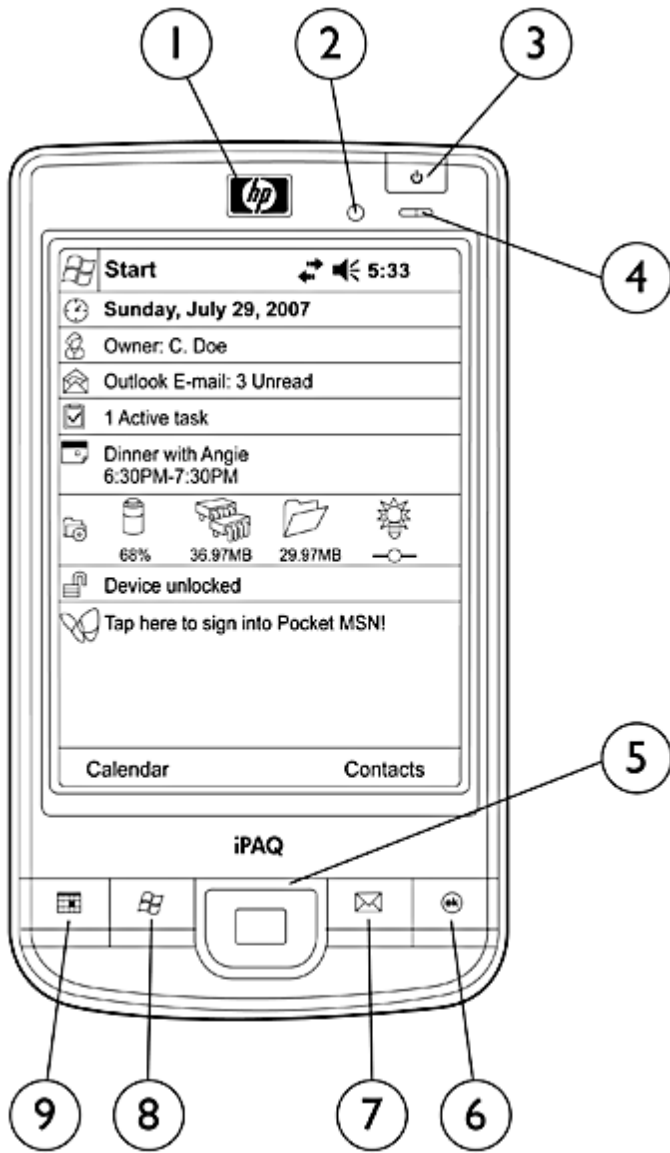

Front

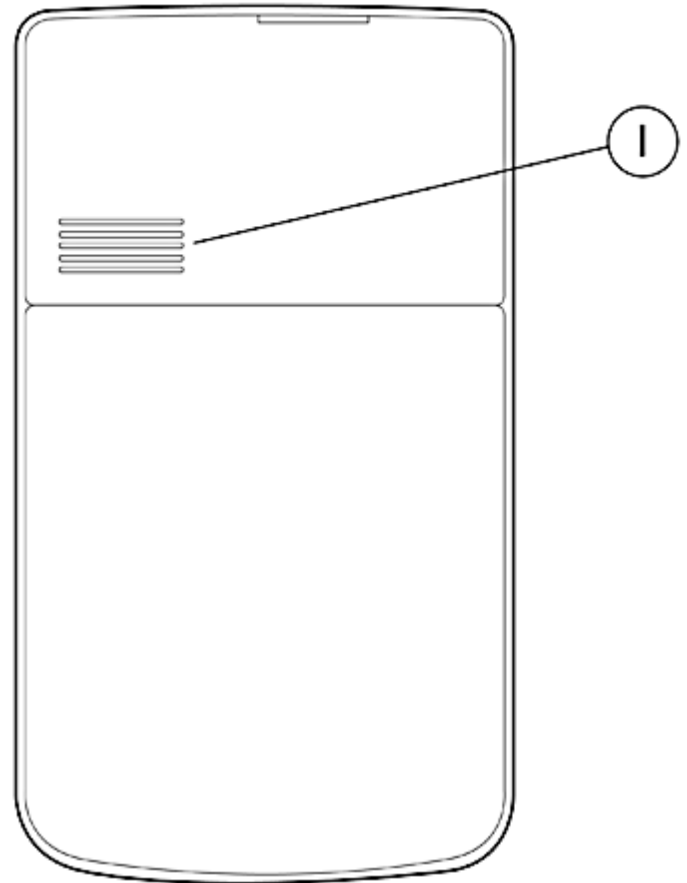

Back

1. Receiver
2. Light sensor
3. Power on/off
4. Power/wireless indicators
5. 5-way navigation; press to activate
6. Launch calendar (press) or contacts (press/hold)
7. Launch Start menu (press) or Today screen (press/hold)
8. OK or close screen (press), rotate screen (press/hold)
9. Messaging (press) or Windows Media Player (press/hold)

1. Speaker

### Overview

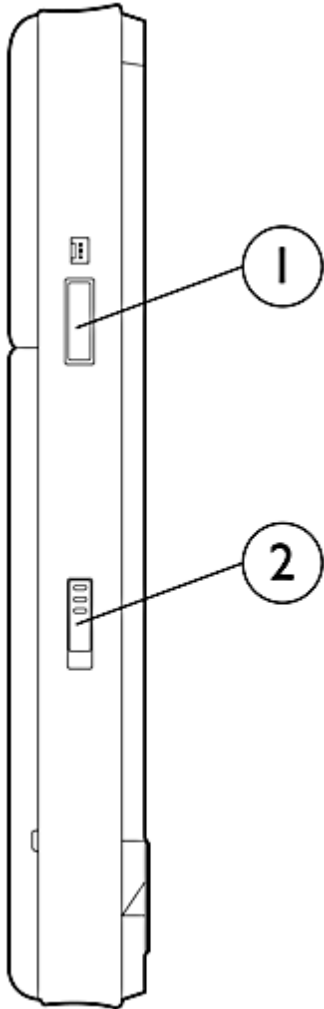

Left Side

1. Voice record button

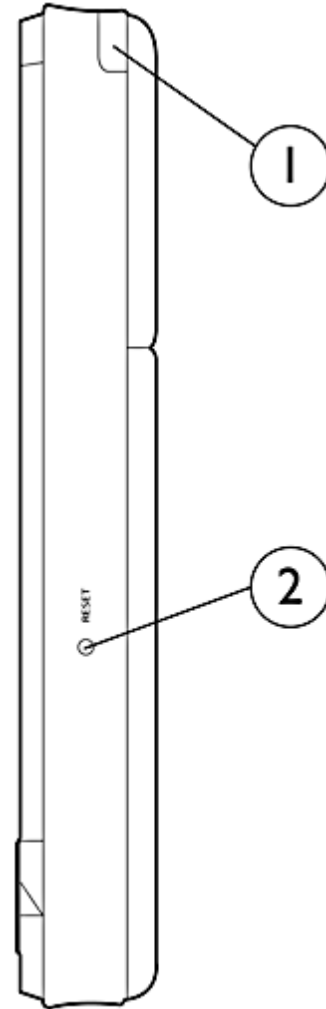

Right Side

1. Stylus
2. Reset

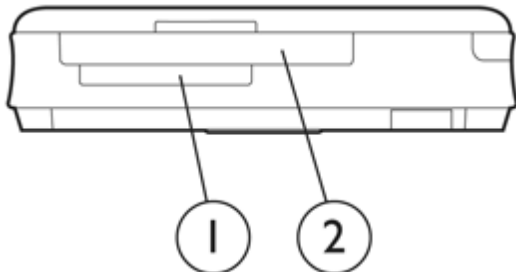

Top

1. SD slot
2. CF slot

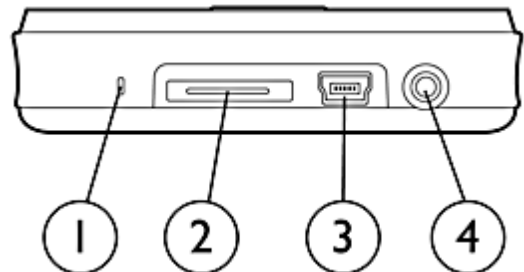

Bottom

1. Microphone
2. 24-pin connector
3. Mini-USB port
4. Headphone jack

### Overview

#### At A Glance

- Processor: Marvell PXA310, 624 MHz
- ROM: 256MB
- RAM: 128MB for running applications
- Display: 4-inch VGA TFT with touch screen, portrait oriented
- Wireless LAN: IEEE 802.11b/g<sup>1</sup>
- Bluetooth: v2.0 with EDR<sup>1</sup>
- Connectors: 24-pin connector and Mini USB
- Battery: 2200 mAh
- Expansion: SDIO (high-capacity), CF
- Headphone jack: 3.5mm 4-pin
- Speaker: 2
- Microphone: 1
- Input: touch, stylus
- Buttons: 5-way navigation with press to activate, 4 programmable, voice recorder, power, reset
- LED: 8
- Operating System: Windows Mobile® 6 Classic Edition

<sup>1</sup> A standard WLAN infrastructure, other Bluetooth-enabled devices, separately purchased equipment, and a service contract with a wireless airtime provider may be required for applicable wireless communication. Wireless Internet use requires a separately purchased service contract. Check with service provider for availability and coverage in your area. Not all web content available.

### Standard Features

#### Model

HP iPAQ 210 Enterprise Handheld

FBO40AA#ABA

United States, Puerto Rico

#### Processor

Marvell PXA310, 624 MHz

**NOTE:** Processor numbering is not a measurement of higher performance.

#### Memory

128 MB SDRAM main memory for running applications  
256 MB flash ROM

#### Display

Type	Transflective color TFT with backlight
Number of Colors	260, 18-bit
Touch Screen	Yes
Resolution (H x W)	640 x 480 pixels
Pixel Pitch	127.5um
Viewable Image Size	4.0-inch diagonal

#### System Unit

Dimensions (H x W x D)	4.96 x 2.99 x 0.63 in. (126 x 76 x 16 mm)	
Weight	Up to 6.8 oz (192 g)	
Operating Temperature	41° to 113° F (5° to 45° C)	
Storage Temperature	-4° to 140° F (-20° to 60° C)	
Operating Humidity	30~85% RH	
Regulatory Marks	<b>Electrical</b>	FCC, C.I.S.P.R, V.C.C.I. Ministry of Commerce, ICES, Australian ACA , Taiwan BSMI, China CCIB, Canadian, Korea RRL, CE)
	<b>Safety</b>	UL, NOM, European Laser, EVPU, SASO, Taiwan, US/Canada, CE

#### Hardware Buttons

9-way navigation with press to activate; 4 programmable keys; voice recorder, power, and reset buttons

#### Audio

Headphone jack: 3.5mm 4 pin support for stereo or VoIP headset  
Two speakers, one microphone, positioned for VoIP

#### Indicators

Alarms	Solid amber power button – battery charging Solid green power button – battery fully charged Flashing blue LED – WLAN and/or Bluetooth active
Notification	Sound and visual message on the display

### Standard Features

Connectors/ Interface(s)	24-pin connector, Mini USB	
Expansion	SDIO and CF card slots	
Power	<b>Battery</b>	Removable/rechargeable 2200 mAh Lithium Ion battery <b>NOTE:</b> Battery run time varies based on the usage pattern of an individual user and the configuration of the handheld. Use of internal wireless capabilities and backlight will significantly decrease battery run time.
	<b>AC power supply ratings</b>	AC Input: 100~240 Vac, 50/60 Hz AC Input current: 0.5 Aac max Output Voltage: 5.2Vdc (typical), Output Current: 2A (typical)
	<b>AC adapter dimensions</b> (HxWxD)	1.8 x 2.8 x 1.2 in (45 x 71.1 x 29.8 mm)
	<b>Power cord length</b> (approx)	5.9 ft (1.8 m)
In the Box	iPAQ 200 Series Enterprise Handheld, sync/charge cable, multi-prong AC charger with appropriate plug adapter for shipping countries, battery, stylus, slip case, documentation kit, and HP iPAQ Companion CD	
Operating System	Windows Mobile® 6 Classic Edition	
Applications/Links	Windows Mobile Office Outlook Windows Mobile Office Internet Explorer Mobile Windows Media Player Mobile Microsoft ActiveSync Windows Mobile Device Center MSN Messenger Games Calculator Audio Recorder	<b>HP Value-Add Applications:</b> Help and Support iPAQ Wireless Manager HP Photosmart Mobile Certificate enroller Asset viewer Bluetooth phone connection manager (BVRP) Today Panel Lite HP Setup Assistant Adobe Reader Real Desktop Audible.com link Handango link Web Registration
	<b>NOTE:</b> Programs may vary based on model. Some programs are accessed through CD links to download web sites.	

### Standard Features

#### Service and Support

One year parts and labor; 90 days technical support for software.  
HP Business Support Center

- iPAQ Active Chat support 24x7
- Email-based support service
- On-line troubleshooting and self-help resources

#### Wireless LAN Specifications <sup>1,2</sup>

IEEE standard(s)	802.11 b/g
Frequency band	2.4000 to 2.97 GHz
Antenna type	PIFA Antenna
Modulation technique	802.11b CCK Mode3, 802.11g OFDM
Receiver sensitivity – packet error rate	1 Mbps: <-93 dBm, PER < 8%, typical
Transmit output power	11 Mbps: <-87 dBm, PER < 8%, typical 54 Mbps: <-72 dBm, PER < 10%, typical 14.0 dBm (typical 802.11b) 12 dBm (typical 802.11x)
Power consumption	Transmit mode: 0.99 Watts, typical Receive mode: 0.99 Watts, typical
Operating distance	Up to 300 feet – open sight

#### Bluetooth® Specifications<sup>1</sup>

Technology	High-speed, low-power, short-range wireless communication with other Bluetooth devices
Specification	Bluetooth 2.0 with EDR (2.4 GHz Industrial Scientific Medical Band)
System interface	UART
Device type	Class 2; up to 4 dBm transmit, typical 10 meter range
Power	Typical TX current at approximately 56 mA Typical RX current at approximately 45 mA

#### Regulatory Compliance

Certifications	UL, FCC, Industry Canada, CE, C-Tick, CCC, RTA, NTC, IDA, DGT, SIRIM, PTA, GOST, SASO, SABS, JTB, WPC, DGPT, MoC, ICASA, Etisalat, VCCI, MIC
RoHS or WEE compliance	

<sup>1</sup> A standard WLAN infrastructure, other Bluetooth-enabled devices, separately purchased equipment, and a service contract with a wireless airtime provider may be required for applicable wireless communication. Wireless Internet use requires a separately purchased service contract. Check with service provider for availability and coverage in your area. Not all web content available.

### Options

**NOTE:** Optional accessories are available as separate purchase.

Storage	HP iPAQ 256MB Micro SD Memory	FA874AA#AC3
	HP iPAQ 512MB Micro SD Memory	FA875AA#AC3
	HP iPAQ 1GB Micro SD Memory	FA876AA#AC3
	HP iPAQ 2GB Micro SD Memory	FA877AA#AC3
Power	HP iPAQ 200 Series Standard Battery	FB036AA#AC3
	HP iPAQ 200 Series Extended Battery	FB037AA#AC3
	AC Adapter 10W(5V 2A)	FA372B#AC3
	HP iPAQ 200 Series Desktop Cradle	FA765AA#AC3
Synchronization	HP iPAQ 200 Series Sync/Charge Cable	FB072AA#AC3
Headphones	HP iPAQ Stereo Wired 3.5mm Headset	FB033AA#AC3
	HP iPAQ Bluetooth (Mono)Headset	FB029AA#AC3
Cases	HP iPAQ 210 Skin Fit Case	FB016AA#AC3
	HP iPAQ 200 Series Belt Case	FB014AA#AC3
Other Accessories	Bluetooth Folding Keyboard (HID)	FA802AA#AC3
	HP iPAQ 200 Series Screen Protector	FB019AA#AC3
	HP iPAQ 200 Stylus Kit	FB020AA#AC3
	HP iPAQ Universal Car Cradle	FA920AA#AC3

### NOTES:

<sup>1</sup> A standard GSM/GPRS/EDGE/UMTS/HSDPA infrastructure, Wi-Fi, other Bluetooth-enabled devices, separately purchased equipment, and a service contract with a wireless airtime provider may be required for applicable wireless communication. Wireless Internet access requires separately purchased Internet service contract. Check with service provider for availability and coverage in your area. Not all web content available. Wireless transmission speeds may vary based upon network capabilities and other conditions. Establishment and continuation of a wireless connection depends on network availability, provider support and signal strength.

<sup>2</sup> Telephone service requires separately purchased contract with a telephone service provider with coverage in your service area. Additional fees may apply for some features, check with your service provider.

<sup>3</sup> Wireless access point required and is not included. Availability of public wireless access points is limited. Wireless Internet use may require separately purchased Internet service contract.

For more information on the HP iPAQ 200 Series Enterprise Handheld, visit <http://www.hp.com>.

©Copyright 2007 Hewlett-Packard Development Company, L.P. The information contained herein is subject to change without notice. The only warranties for HP products and services are set forth in the express warranty statements accompanying such products and services. Nothing herein should be construed as constituting an additional warranty. HP shall not be liable for technical or editorial errors or omissions contained herein. Microsoft and Windows are U. S. registered trademarks of Microsoft Corporation. Windows Vista is either a registered trademark or trademark of Microsoft Corporation in the United States and/or other countries. Bluetooth is a trademark owned by its proprietor and used by Hewlett-Packard Company under license.